

MiBOXER[®]

Mi • Light Subordinate New Brand

WiFi 5 in 1 LED Strip Controller

Model No.: WL5

Please read the instructions carefully before using the controller.

1. Features

The controller is adopted by the most advanced PWM control technology, and has memory function(The light status will keep same as the status before you turn off the light);Wireless and 4G controlled by MiBoxer APP.



Support Third Party Voice Control



WiFi Wireless Control



Smart phone App control



Compatible with 2.4GHz RF Remote Controller



RGB colors to choose



Dimmable Saturation control



Color temperature 2700~6500K



Timing ON/OFF the lights



Group control randomly by APP



16 Color Changing modes



2. Parameters

Model No.: WL5

Input Voltage: DC12V~24V (5.5*2.1mm) ⊖ ⊕

Output: 6A/Channel (Total Output Max.15A)

Working Temperature: -20~60°C

Communication Mode: WiFi-IEEE 802.11b/g/n 2.4GHz

RF: 2.4GHz Transmitting Power: 6dBm

Weight: 65g

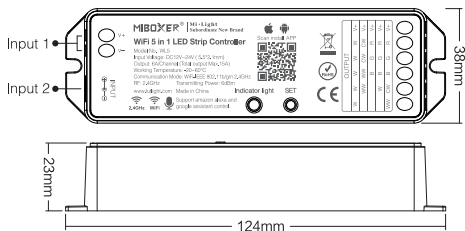

SET Button: Long press "SET" for 3 seconds; When red indicating light blink quickly, device reset and go into Smart Link mode.

Indicating light instruction:

Red light always-on	Red light blinking	Green light always-on	Green light blinking	Yellow light blinking
Disconnected from network	Smart Link mode	Networking successfully	Received signal	Device malfunction

3. Auto-synchronization function

Different controllers can work synchronously when they are started at different times, controlled by the same remote, under same dynamic mode and with same speed.

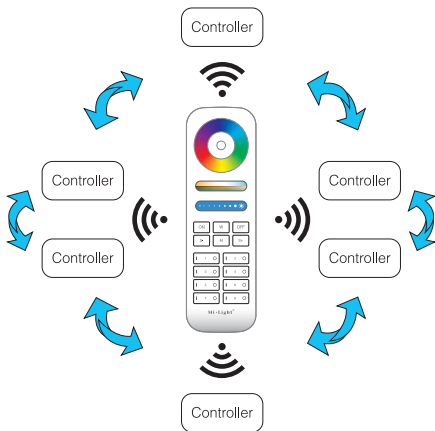

Remark:

1.  Indicating Auto-transmitting.
2. Controller will be auto-synchronizing in the same dynamic modes and within 30m controlling distance.

4. Auto-transmitting Diagram

One strip controller can transmit the signals from the remote control to another controller within 30m, as long as there is a strip controller within 30m, the remote control distance can be limitless.

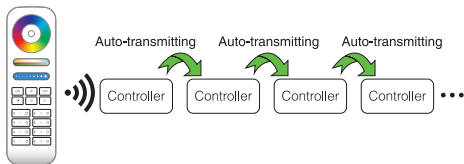

5. Connect to LED strip diagram

 Controller input voltage must be in accordance with the required voltage of LED Strips.

Connect to Single Color LED strip diagram



Connect to CCT LED strip diagram

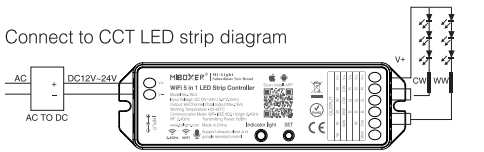

Connect to RGB LED strip diagram

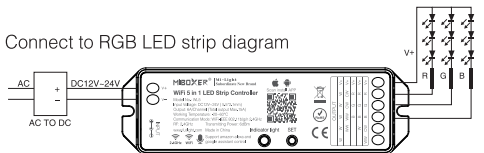

Connect to RGBW LED strip diagram

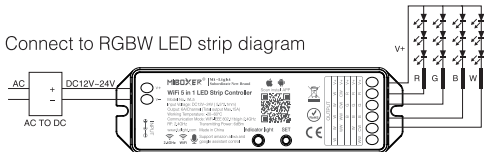

Connect to RGB+CCT LED strip diagram

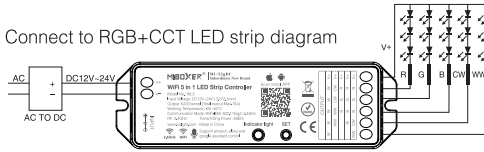

6. Remote Controller

Compatible with these remote controls (Purchased separately).
For more details, pls read the remote instruction.



FUT089



FUT092



FUT088



FUT095



FUT096



FUT006



FUT007



FUT091



B1 / T1



B2 / T2



B8



B4 / T4



B3 / T3



B0

Attention

1. Please check whether the input voltage of the constant voltage power supply is in accordance with the controller, and please check the connection of both the cathode and anode.
2. The working Voltage is DC12~24V, the controller will be broken if the voltage is higher than 24V.
3. Non-professional user cannot dismantle the controller directly, otherwise, it may cause fire and electric shock.
4. The working temperature is -20~60°C; Do not use the device to direct sunlight, moist and other high temperature area.
5. Please do not use controller around the mental area and high magnetic field, otherwise, it will badly affect the control distance.



www.futlight.com

Made in China



MiBoxer APP

User Instruction

1 APP Downloading

For IOS System: Pls search "MiBoxer" on APP store. (Above IOS9.0)

For Android System: search "MiBoxer" on Google Play (Above Android 5.0) or Scan below QR-code to download APP.



Scan QR Code to Install APP



Download on the
App Store



GET IT ON
Google Play

2 Register MiBoxer Account

Open APP and click Register button; Complete the register and log in.

Mobile 10:18 95%

MIBOXER®
MI • Light Subordinate New Brand

United Kingdom +44 >

Mobile number / Email address

Password

I agree [Service Agreement](#) and [Privacy Policy](#)

Log in

Register

Authentication code login Forgot Password

3 Add Device

1. Click the right top "+" on the device list.
2. Please select the device type you will add, then complete the adding according to the hint of APP.
3. Back to device list after adding successfully, then pull down refresh in list to get the device status.

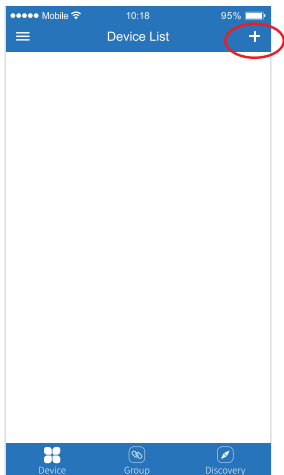



4 Modify device name or delete device

Slide device list to left, click " **Edit** " to modify device name; click " **Delete** " to delete device.

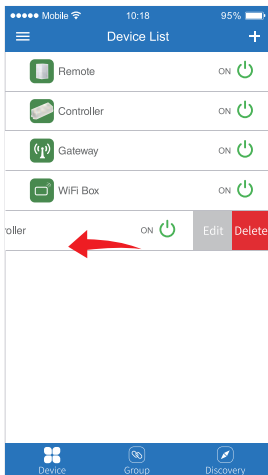
Note: If the device was shared to others, then the device will also be deleted on your friends' device list.



5 Group Control



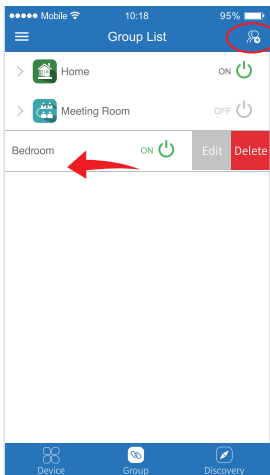

1. Click  to switch to Group list, then click the right top  icon on the Group list to create groups.
2. Slide the Group list to left to **Edit / Delete** groups.

Note: The group just work on APP Controlling, cannot work on Voice control. Please open third party APP for Group Voice control.



6 APP Control

Click the device or group that you want to dim on device list and group list into Dimming Interface.

-  Click speed+ under dynamic mode.
-  Click speed- under dynamic mode.
-  Sunset mode: Gradually OFF within 10 minutes.
-  Good night mode: Gradually OFF within 1 minute.

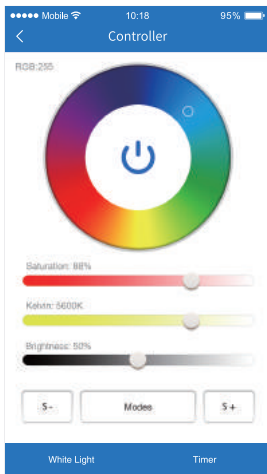

7 Third Party Voice Control instructions

Search "Mi-Light Smart" on third-party platform APP and set up.

Click left top "☰" icon on the home page;

Then click "  Voice Control " to check detailed instructions.

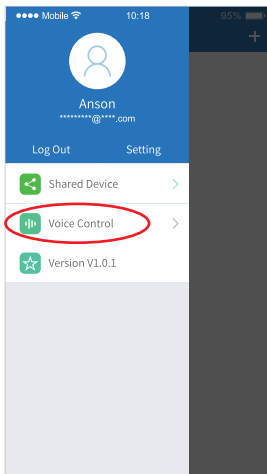

8 Sharing Device

Share the device to friends, Let your friends can control this device.

1. Click the left top "☰" icon on the home page.
2. Click "Shared Device" to My sharing, then click "Add sharing"
(Note: the receiving sharing device cannot be shared again).
3. Click "Jack jack@milight.com" to edit sharing, slide to left to delete sharing.

