

# Quick start guide

## first configuration of BleBox controllers

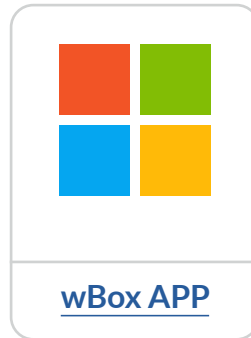

# Table of contents

<b>1</b>	How to use <b>wBox</b> app	p. 2
	1.1 Account	
	2.1 Tutorial of the wBox application	
<b>2</b>	How to configure a new <b>BleBox</b> device	p. 3
	2.1 Connect the phone with the BleBox controller	
	2.2 Configure a new BleBox device	
	2.3 Turn off or set password to BleBox AP	
<b>3</b>	How to add configured <b>BleBox</b> device to another account	p. 7
	3.1 Search for BleBox controllers connected to the WiFi network	
	3.2 Sharing controllers via e-mail	

for more information please visit the website

[www.blebox.eu](http://www.blebox.eu)

or send an email to: [info@blebox.eu](mailto:info@blebox.eu)

technical support is available at: [support@blebox.eu](mailto:support@blebox.eu)

proudly made by  
**blebox**

1.1

At the launch of wBox app, it will ask you to log in or create an account.

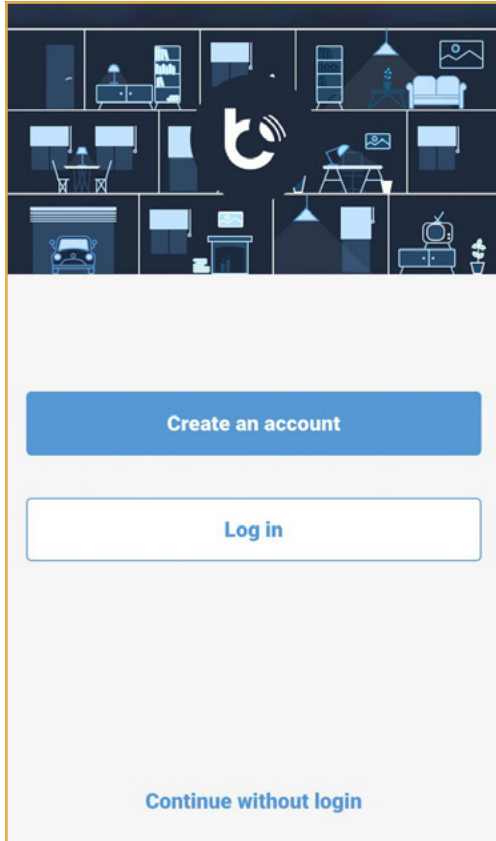

You can create the **BleBox** account or log in using your **Google**, **Apple** or **Facebook** account.

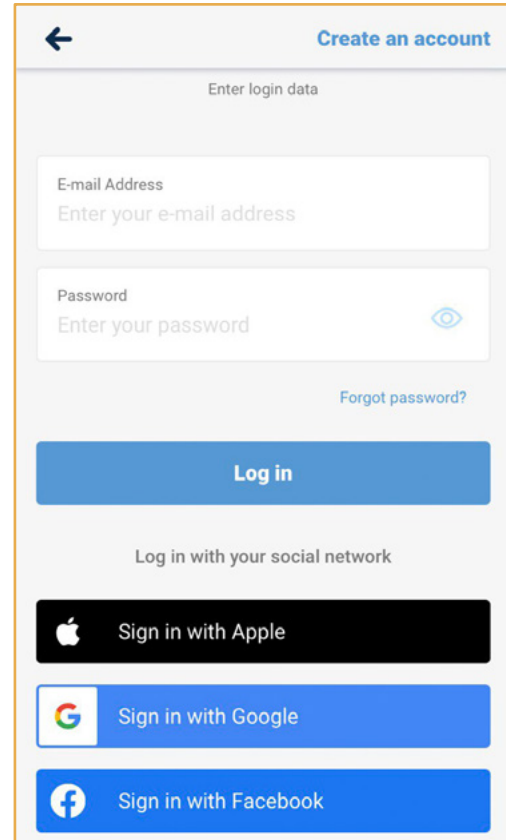

You can continue without login (dedicated for installers for one-time connection of the controller), but the features of the app will be limited.

**We strongly recommend to create an account or log in.**

## 1.2 How to use wBox app - wBox app Tutorial

1.2

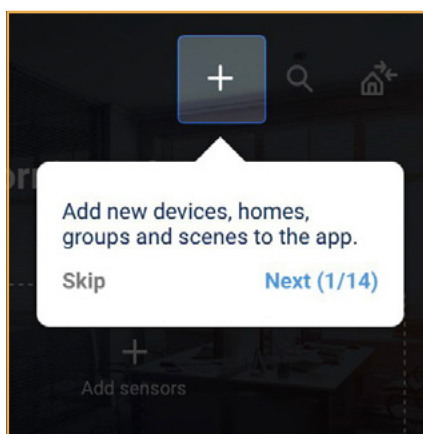

After logging in, the **wBox** tutorial will automatically appear.

If you don't see the tutorial, click on the „Menu”, ☰ and then on „How to use”.

2.1

Connect the phone with the **BleBox** controller.

iOS version

iOS



Please turn off mobile network/  
cellular data in your phone.

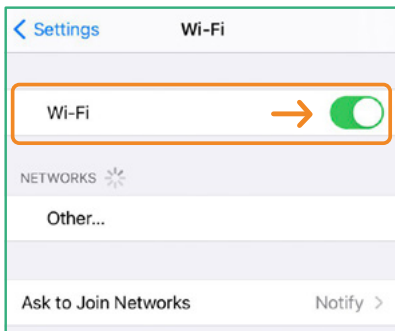

Please select WiFi settings in  
your phone and turn on WiFi  
network.

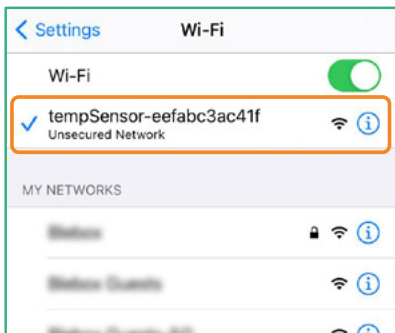

Connect to the WiFi network  
provided by the controller, for  
example: - „device-xxxxxxx“,  
where xxxxxxxx is the  
unique number of the device.

Android version

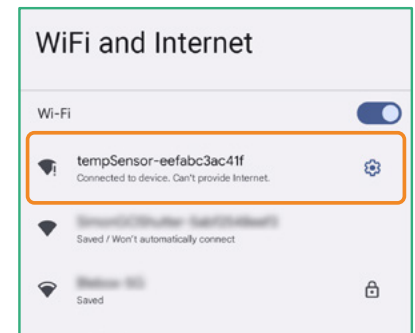
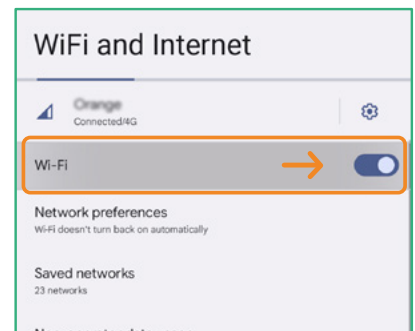
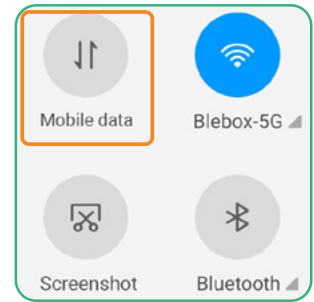

**Connected!**

Some phones may report that **“Internet may not be available”** - it's normal, please continue with this WiFi network.

After connecting to the WiFi network of the **BleBox** controller, return to the **wBox** application .

# Version A

Please use „+ Add device to account” button to add the device to your account. Now you became the owner of the device.

1

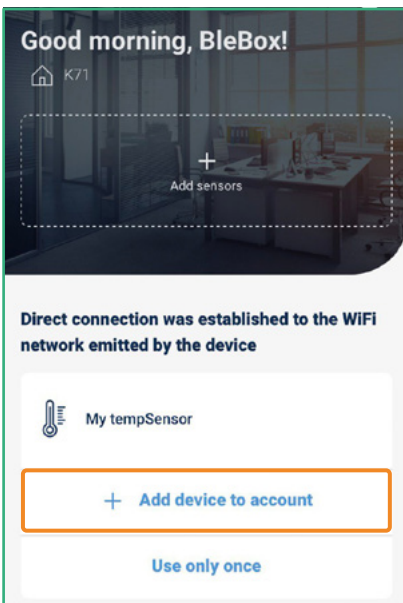

Ready!

You have added the device to your account. Then „Go to WiFi settings”.

\* If the message did not appear or you clicked „Cancel”, please refer to version B (page 5).

2

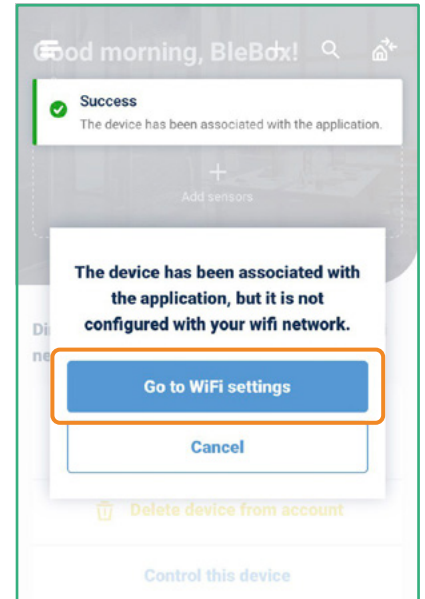

Select your home WiFi network from the list to connect the controller with this network.

3

Remember!

The owner of the device has the right to grant and revoke access to the device to other users.

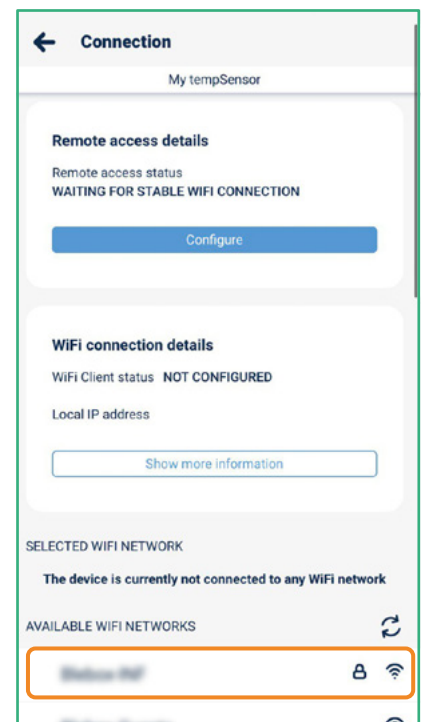

WiFi Client status: connected!

The BleBox controller is connected to your home WiFi network.

Further part of the manual: - page 6, p.2.3

5

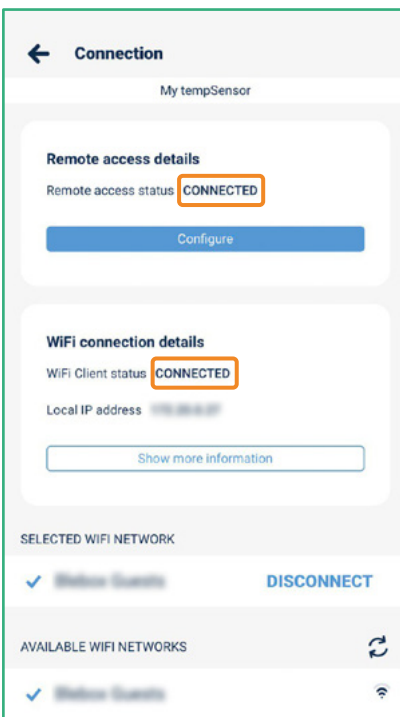

Enter your home WiFi password, then click „Connect”.

4

# Version B

If you didn't see a message after adding the device to your account or you clicked „Cancel”, go to WiFi network settings. Select „Control this device”.

1

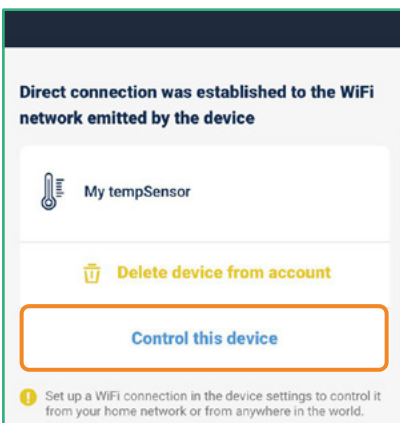

Find and click the settings icon ⚙️.

2

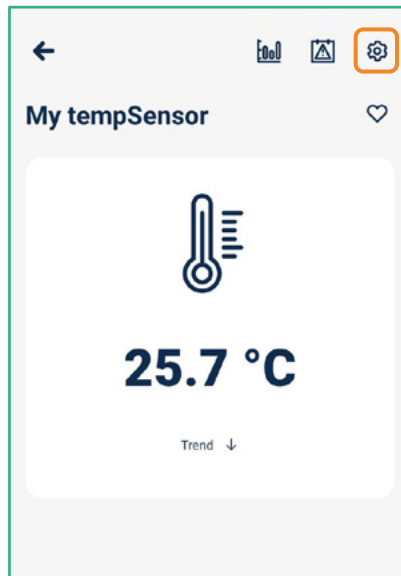

Click on „Connection”.

3

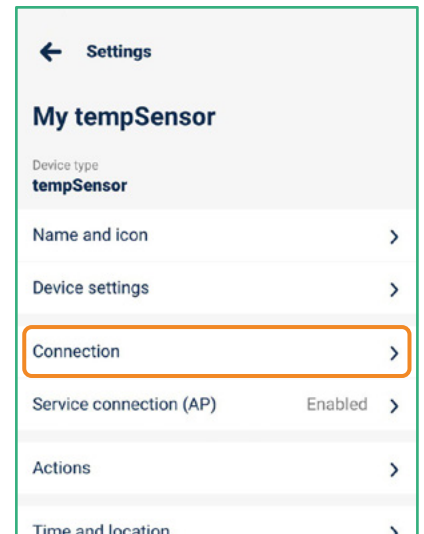

Select your home WiFi network from the list to connect the controller to this network.

4

### Remember!

The owner of the device has the right to grant and revoke access to the device to other users.

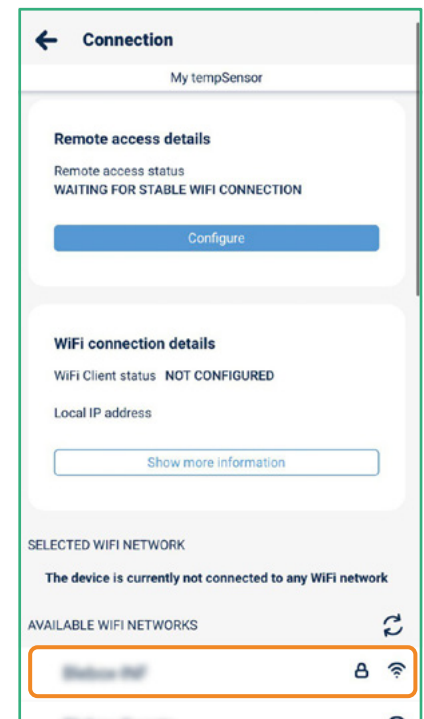

WiFi Client Status: Connected

The BleBox controller has been connected to the home WiFi network.

6

Enter your home WiFi password, then click „Connect”.

5

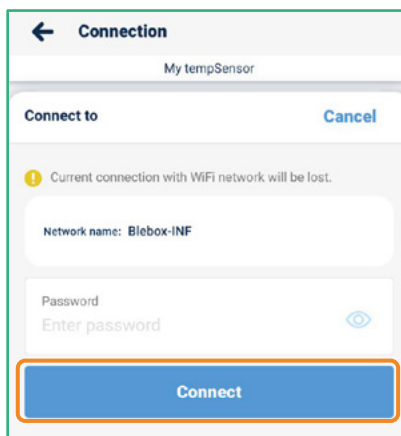
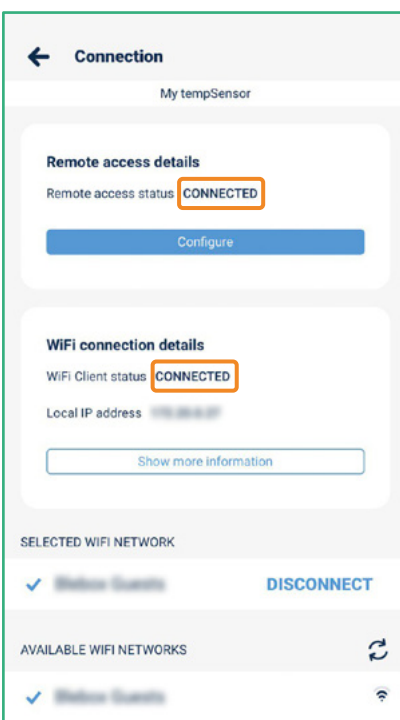

## 2.3

Disable or set a password for the service connection.

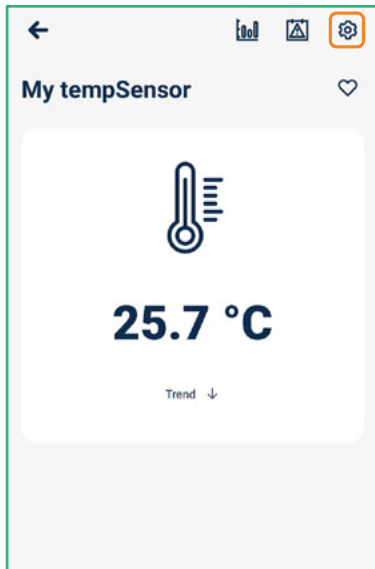

Click the settings icon .

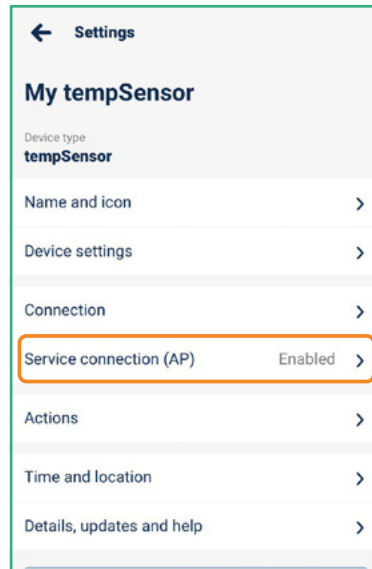

Go to the „Service Connection (AP)” section.

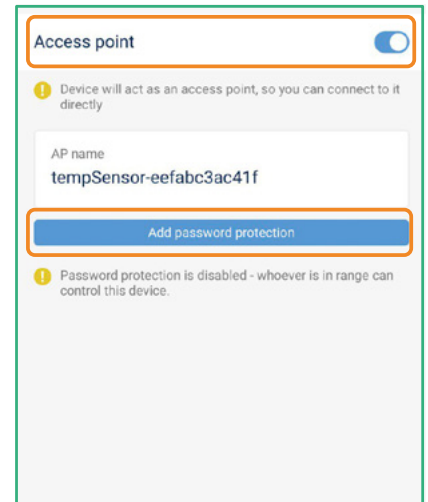

Here you can **disable the access point** or **set a password for the AP to prevent unauthorized access.**

### That's all!

For more information about your specific device, see the user guides.

Please continue below if you want to see how to share a configured device with another family member.

3.1 Add configured controller using another smartphone.

Find the „+” icon at the top of the screen.

1

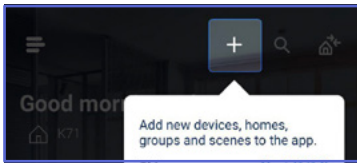

Click „Add New Device”.

2

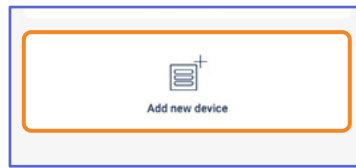

Select „Add devices already connected to the WiFi network”.

3



Click „Finish”, the drivers will be added.

6

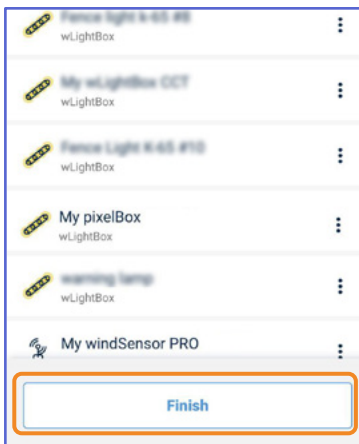

Select the devices you want to add to your account and press „Save”.

5

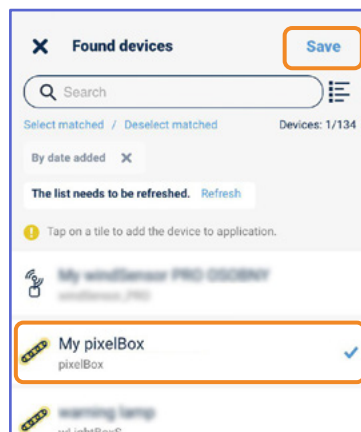

Select „Scan for devices” for devices and wait for the scan to complete.

4

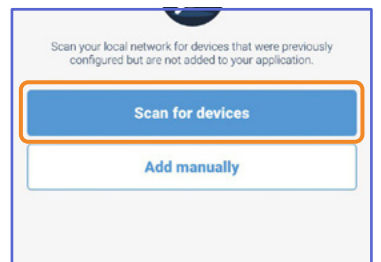

Remember that you must be connected to the same WiFi network as the BleBox controller.

**That's all!**

You can go back to the dashboard or add controllers to specific home.

3.2

Sharing controllers via e-mail.

Use “Sharing management” option in wBox app menu ☰.

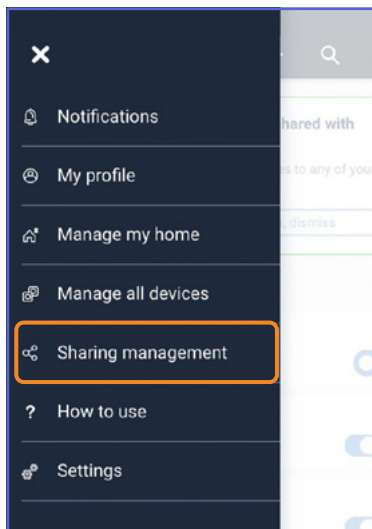

Use share option in μPortal <https://portal.blebox.eu>.

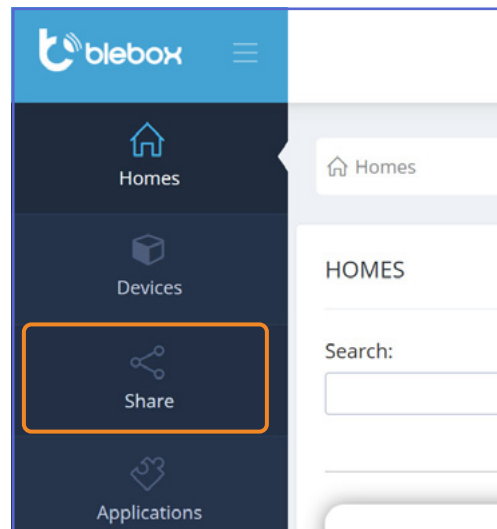

for more information please visit the website

[www.blebox.eu](http://www.blebox.eu)

or send an email to: [info@blebox.eu](mailto:info@blebox.eu)  
technical support is available at: [support@blebox.eu](mailto:support@blebox.eu)

proudly made by  
**blebox**